

REFERENCE PLAN
**COVID-19 TESTING LABORATORY
 USING CARTRIDGE-BASED TECHNOLOGY
 SARS-CoV-2 ASSAY**

LEGEND:

1. BIOLOGICAL SAFETY CABINET (BSC)
2. LABORATORY CHAIR
3. LABORATORY DEEP SINK
4. MICROCENTRIFUGE
5. VORTEX MIXER
6. PASS BOX
7. COMPUTER CHAIR
8. WASTE BIN
9. HAND WASHING SINK
10. PCR MACHINE (E.G. GENEXPERT)
11. COMPUTER
12. WORK COUNTER
13. REFRIGERATOR
14. FREEZER
15. STORAGE CABINET
16. AUTOCLAVE

NOTES:

- THIS PROTOTYPE IS ONLY FOR COVID-19 TESTING LABORATORY USING CARTRIDGE-BASED TECHNOLOGY SARS-CoV-2 ASSAY (E.G. GENEXPERT).
- THE PROPOSED COVID-19 TESTING LABORATORY SHOULD BE LOCATED IN A SEPARATE LOCATION/ OUTSIDE AN EXISTING INSTITUTION WHERE THERE IS LESS FOOT TRAFFIC FOR THE PROTECTION OF STAFF AND PUBLIC.
- OTHER SUPPORT SERVICES AREAS (E.G. WASTE HOLDING AREA), TOILET AND OTHER STAFF AMENITIES CAN BE LOCATED IN A SEPARATE AND EXISTING ADJACENT STRUCTURE.

GRAPHICAL SCALE:



 <p>Republic of the Philippines DEPARTMENT OF HEALTH CENTRAL OFFICE Rizal Avenue, Sta. Cruz, Manila City</p>	TITLE	NOTED BY:	SHEET NO.
	SAMPLE FLOOR PLAN COVID-19 TESTING LABORATORY	ATTY. NICOLAS B. LUTERO III, CESO III DIRECTOR IV, HEALTH FACILITIES AND SERVICES REGULATORY BUREAU, DOH	
			PRPD BY: HFSRB-SDD

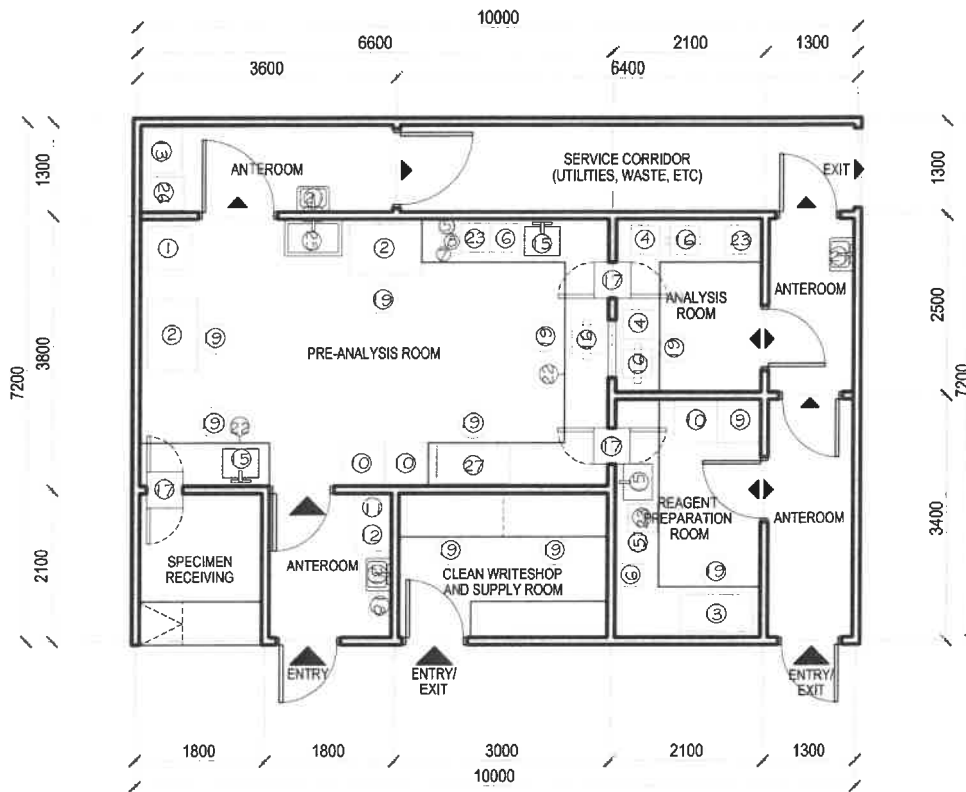

REVISED PROTOTYPE PLAN FOR
COVID-19 TESTING LABORATORY
 PERFORMING MANUAL RNA EXTRACTION
 rRT-PCR

LEGEND:

1. AUTOCLAVE
2. BIOLOGICAL SAFETY CABINET (BSC)
3. LAMINAR AIRFLOW (LAF) HOOD
4. REAL TIME POLYMERASE CHAIN REACTION (RT-PCR) MACHINE
5. VORTEX MIXER
6. MICRO CENTRIFUGE
7. PIPETTORS
8. PIPETTE FILTERED TIPS
9. FREEZER
10. REFRIGERATOR
11. PERSONAL PROTECTIVE EQUIPMENT (PPE) CABINET
12. PERSONAL PROTECTIVE EQUIPMENT (PPE)
13. FIRST AID KIT
14. COLD RACK
15. LABORATORY DEEP SINK WITH EYE WASH
16. COMPUTER
17. PASS BOX
18. WASTE BIN
19. LABORATORY STOOL
20. COMPUTER CHAIR
21. HAND WASHING SINK WITH EYE WASH
22. LABORATORY COUNTER
23. MINIFUGE
24. CONVENTIONAL PCR MACHINE
25. STAINLESS STEEL UTILITY SINK
26. SPILL KIT
27. PCR HOOD

NOTES:

- THIS PROTOTYPE IS ONLY FOR COVID-19 TESTING LABORATORY PERFORMING MANUAL RNA EXTRACTION rRT-PCR.
- THE PROPOSED COVID-19 TESTING LABORATORY SHOULD BE LOCATED IN A SEPARATE LOCATION/ OUTSIDE AN EXISTING INSTITUTION WHERE THERE IS LESS FOOT TRAFFIC FOR THE PROTECTION OF STAFF AND PUBLIC.
- OTHER SUPPORT SERVICES AREAS (E.G. WASTE HOLDING AREA), TOILET AND OTHER STAFF AMENITIES CAN BE LOCATED IN A SEPARATE AND EXISTING ADJACENT STRUCTURE.

GRAPHICAL SCALE:



 <p>Republic of the Philippines DEPARTMENT OF HEALTH CENTRAL OFFICE Ruffa Avenue, Sta. Cruz, Manila City</p>	TITLE	NOTED BY:	SHEET NO.
	SAMPLE FLOOR PLAN COVID-19 TESTING LABORATORY	ATTY. NICOLAS B. LUTERO III, CESO III DIRECTOR IV, HEALTH FACILITIES AND SERVICES REGULATORY BUREAU, DOH	PRPD BY: HFSRB-SDD