

SAMPLE FLOOR PLAN
SCALE 1:75m GROSS FLOOR AREA: 72.2 m² (9.5 m x 7.6 m)



Republic of the Philippines
DEPARTMENT OF HEALTH
CENTRAL OFFICE
San Lazaro Compound, Rizal Avenue, Sta. Cruz, Manila City

TITLE / SHEET CONTENT:
**SAMPLE FLOOR PLAN FOR
PRIMARY CARE FACILITY**

APPROVED BY:
[Signature]
MARIA ROSARIO SINGH - VERGEIRE, MD, MPH, CESO IV
O.I.C.- UNDERSECRETARY OF HEALTH,
HEALTH REGULATION TEAM, DEPARTMENT OF HEALTH

SHEET NO. 1 OF 1
REVISION 0.0
09/30/2020
PREPARED BY:
HFSRB-SDD

ANNEX C-3b
AO 2020- 0047

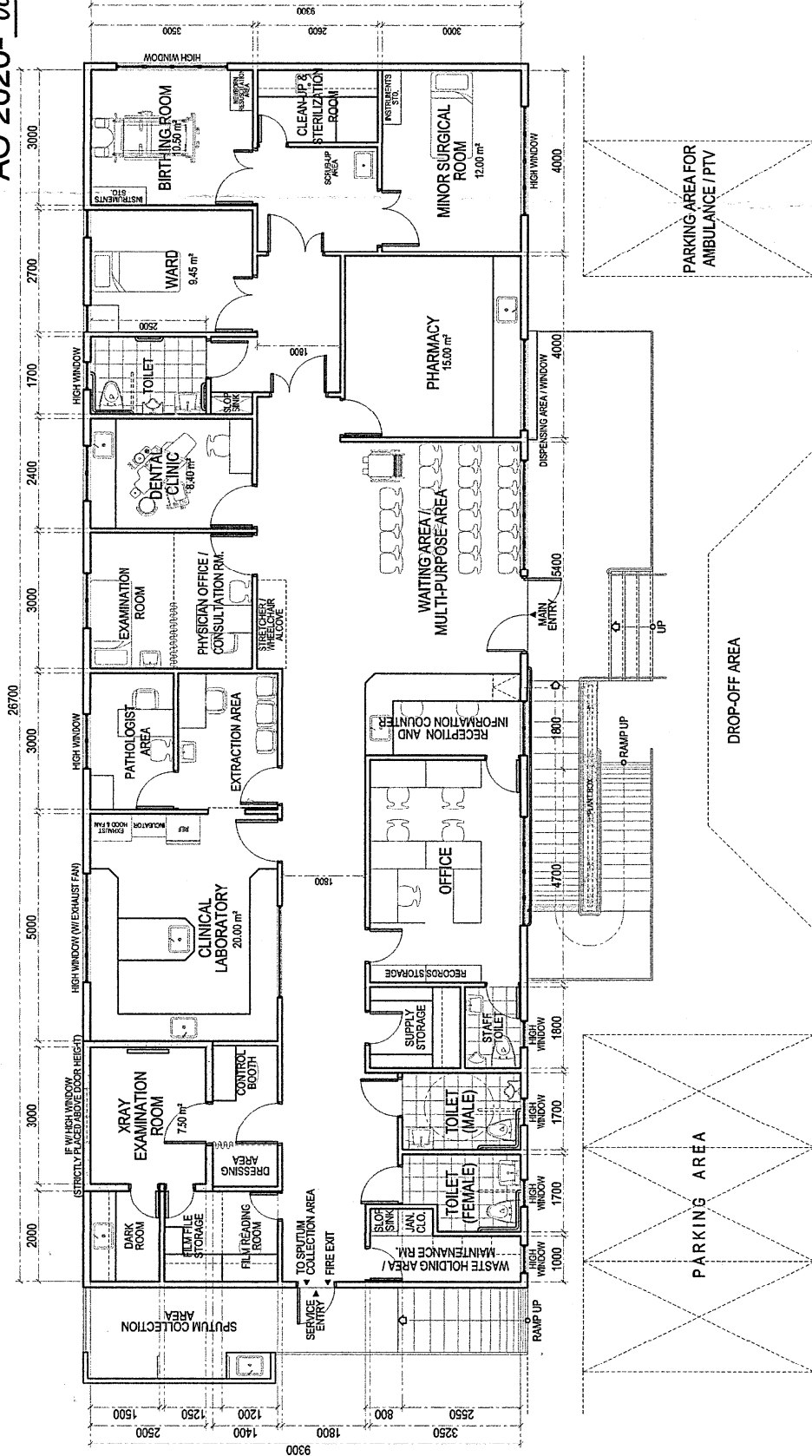

SAMPLE FLOOR PLAN
SCALE 1:125 m GROSS FLOOR AREA: 246.3 m² (26.7 m x 9.3 m)

<p>DEPARTMENT OF HEALTH CENTRAL OFFICE San Lazaro Compound, East Avenue, St. Cruz, Manila City</p>	<p>TITLE OF HEALTH CARE FACILITY: SAMPLE FLOOR PLAN FOR PRIMARY CARE FACILITY</p>	<p>SHEET CONTENTS: SAMPLE FLOOR PLAN FOR PRIMARY CARE FACILITY (WITH ALL ANCILLARY SERVICES)</p>	<p>APPROVED BY: <i>[Signature]</i> MARIA ROSARIO SINGH - VERGEIRE, MD, MPH, CESO IV O.I.C. - UNDER SECRETARY OF HEALTH, HEALTH REGULATION TEAM, DEPARTMENT OF HEALTH</p>	<p>SHEET NO. 1 OF 1 REVISION 0.0 09/30/2020 PREPARED BY: HFSRB-SDD</p>
--	--	---	--	--